



TAMPA PALMS NEWSLETTER

June 2013



Guess Who Is Coming To Tampa Palms...



Cappy's Pizzeria Launches In City Plaza

The iconic Cappy's Pizza is bringing its great food and warm atmosphere to our own City Plaza.

Grand Opening Target Date Mid July 2013

A small group of close-knit friends created Cappy's in South Tampa in 1995. Since then they have expanded Cappy's, adding locations in Seminole, Brandon and St Pete— each with a unique appeal to the neighborhood.

By all accounts (Creative Loafing Best of the Bay, AOL Dining,) Cappy's is such a success because of its focus on:

- Using premium ingredients for everything— from the pies to the calzones to the salads.
- Maintaining a fun vibe in an affordable family restaurant.

No details are released yet about the interior for the Tampa Palms location except to say it will have an industrial look with cool wall art as in all the other Cappy's.

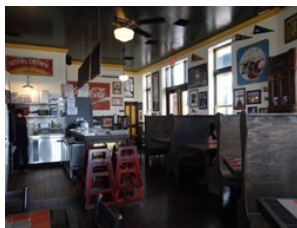

Mateo Ramos Opens His Casa Ramos In The Shoppes at Amberly

The waiting is almost over... Tampa Palms will soon have a restaurant in the Mexican dining sphere

Opening June 2013

Casa Ramos (and its sister eateries - Azteca) have a reputation for good food and good fun across the country, with locations from their original home base in the Pacific Northwest to Florida.

Started in 1978 by Pepe Ramos and his three brothers from Cuautla, Mexico, the Casa Ramos/Azteca group is truly a hands-on, family work of love.

Mateo Ramos (nephew to Pepe) is opening his first Casa Ramos in Tampa Palms.

The dishes depicted here are from the Azteca/Casa Ramos website; colorful Mexican fare made from fresh ingredients and served in a fun fiesta atmosphere.





News From the TPOA



On June 7th Classes Are Over For The Summer

Summer is a wonderful time for everyone— especially our children .

No matter how often or how well mom and dad instruct little ones about pedestrian, auto and bike safety, excited children running to meet friends can sometimes forget it all for a moment or two and that is all it takes for tragedy to strike.

It is up to us to keep a careful eye out - even more so near the many places where children gather in Tampa Palms, such as Compton Park, the Country Club, the YMCA, Amberly Park and Hampton Park.



Compton Swimming Pool Bustling With Activity

The warm weather and school vacations make the Compton Park pool THE destination for many Tampa Palms neighbors. Here are a few reminders to help make the pool experience a fun and safe one for all.

The Compton pool is reserved for residents of Tampa Palms Areas. Residents may bring 2 guests per household.



The pool is not available to reserve for parties .

Pool Rules - For The Safety of All

- Children under 13 years must be accompanied by an adult in the pool area
- **Adults must be IN THE POOL with any children under 8 years old.**
- No more than 65 persons are permitted in the pool area at one time.
- The pool should not be used unless two or more people are present.
- Pool will be closed when air temperature is 50 degrees or below.
- No running, pushing or horseplay will be tolerated. Violators will be asked to leave the premises.
- No food, beverages or glass containers are permitted on the pool deck.
- Food & beverages are permitted in the pavilion.
- No alcohol or smoking permitted within the fenced pool area.
- No animals, except service animals, are permitted within the fenced pool area.
- No rafts, air mattresses, air rings, balls, buoys, facemasks, snorkels or fins are permitted in the pool. Arm floats, "Noodles" and goggles are permitted
- Personal radios and music device should be kept at a low level so as not to disturb others.
- Shower before entering the pool.
- All bathers must immediately leave the pool area during electrical storms

AAA Insurance Agency can handle all your insurance needs



AUTO



HOME



FLOOD

Talk with a licensed AAA Insurance Agent and get a quote today!

Roxanne Moats
(813) 929-3430
Extension 2227
RLMoats@aaasouth.com

AAA New Tampa
20315 Bruce B. Downs Blvd.
(813) 929-3430
AAA.com/NewTampa



AAA Insurance Agency offers insurance products underwritten by AAA affiliated companies and/or non-affiliated companies. 13-IA-1473 LC 12/12



The Bank of Tampa

BANKING • INVESTMENTS • TRUST

Tampa Palms Office

Leslie N. McCabe-Holm, CFP®
Banking Office Manager

James A. Schoolfield
Assistant Vice President, Commercial Banking

15302 Amberly Drive
813-998-2620

www.bankoftampa.com

Member FDIC



Tampa Palms Property Values Climb



Many in Tampa Palms have inquired as to “how is Tampa Palms property value in the area holding up now that there appears to be some recovery in real estate”.

The long slide in the value of property which began 2008 has finally begun to ease. The value of Tampa Palms property, which was slightly less than \$814 Million at the end of 2008 according to the Property Appraiser, slumped to \$602 Million by the end of fiscal year 2011-12, a loss of 26% in property value.

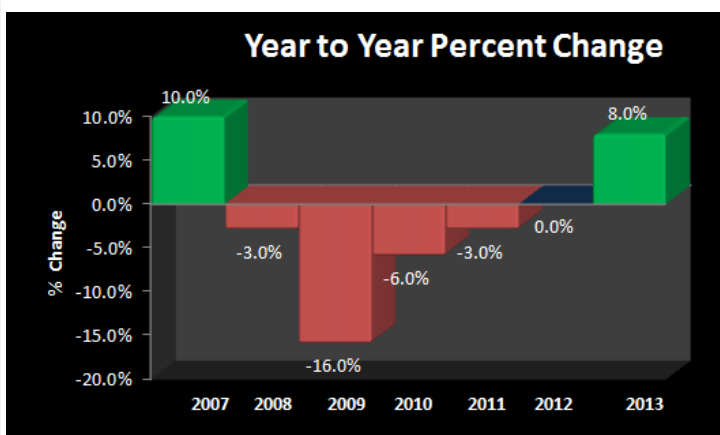

For 2013 the Property Appraiser lists the value of Tampa Palms property as \$648 Million, an 8% increase over the prior year.

Zillow, an online national real estate database founded by two Microsoft executives in 2005, has a more optimistic view of the increase in value of Tampa Palms. According to Zillow, the year to year increase in the value of Tampa Palms property is 13.6%.

Selected Communities - % Increase

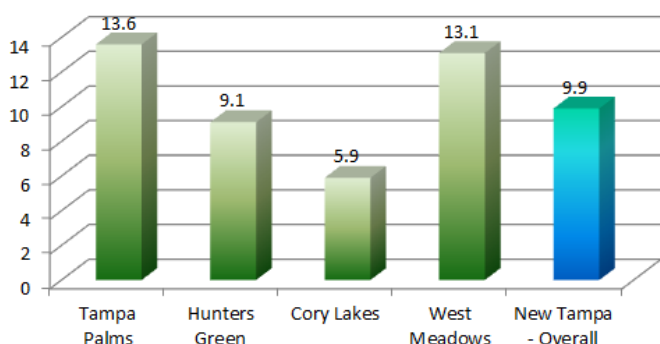

Zillow Home Value Index Y-O-Y May 2013

Tampa Palms Total Property Value By Year

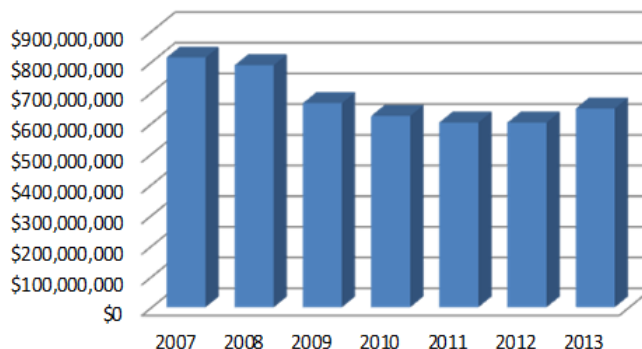

County-wide there was an increase of value of slightly more than 5%, as reported by the media. In contrast to the more conservative Property Appraiser view, Zillow reports an 11.6% county-wide increase in value.

The respected Corelogic- Case Shiller reports a nationwide 7.3% increase in single family home value in the last year and forecasts a more modest 3.9% annualized trend through 2017. (See chart below)

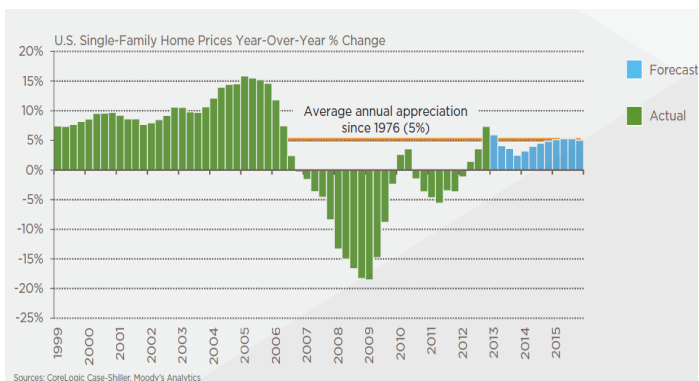

Bonnie French, who as TP Property Manager keeps track of the sales and sale prices of homes in the community, suggested that despite the fact that Tampa Palms has no new construction (which serves to increase overall reported values), **Tampa Palms remains a “hot property” in part due to the care and investment in the homes by the owners.**

Bonnie noted that her office is flooded with RMC approval requests and a trip down almost any street in the community reveals contractor trucks and landscape improvements in-progress or just completed.



Swimming Pool Season Is Here

A Word About Child Safety

There are a lot of pools in Tampa Palms – more than 80% of the homes have a pool or a spa. In addition to the back yard pools, there is also the Compton Pool and the YMCA pool readily available. There is no question, Tampa Palms children have access to swimming pools.

As much fun as pools are for children and whole families, there are also significant dangers:

Drowning is the most common cause of death for children under four years in Florida. Most drowning happen in private pools and can happen when caregivers are distracted for just seconds. Stunning statistics in Florida reveal that:

- 65% of child drowning occurs in the home pool
- 69% of the child drowning occurs while one or both the parents are responsible for supervision.
- 77% of the children who drowned were seen less than five minutes before they were discovered in the pool.

The three pillars for pool safety include

- Supervise children at all times when near the pool
- Make certain proper barriers, alarms and latches are in place and operating properly.
- Know what to do in an emergency (CPR) and have phones nearby to call for help.

Now is the time to inspect fences, self-closing and latching gates, baby barrier fences, and alarms.



This is also a good time to check with your pool maintenance company and have them make certain the entrapment prevention system for your pool is in proper working order.

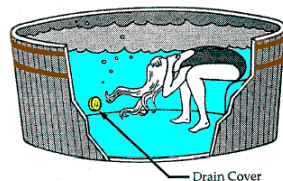

Water safety experts recommend “layers of protection”. This is not one solution but rather a full spectrum of strategies with the ultimate goal of preventing pool accidents and drowning's.

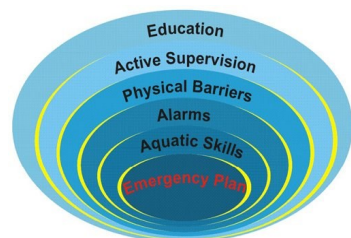

Pools Are Fun When They Are Safe

Vacation Plans In The Works?



If you are planning to get away for a little vacation, don't forget to do a little security planning before you go. Here are five easy steps that security professional recommend you consider to keep your home safer.



1. Ask a friend to help

A simple, way to gain peace of mind while traveling is to ask a friend or neighbor to keep an eye on your house away and to pick up sales fliers left at your home. He or she should also have your contact information and a copy of your itinerary in case of emergencies.

2. Don't tip off criminals with Twitter or Facebook



Would you announce to a crowd that you will be leaving your house unattended for a time? If not, then you should think twice about posting your detailed vacation plans on Twitter or Facebook. Be careful about that phone message as well. Callers don't need to know that you're not home just that you can't come to the phone right now.

3 File a Vacation Watch request with Tampa Police

With the Vacation Watch Program you can leave your residence for a weekend or a month knowing that Tampa Police Dept will be checking it for you.

It's simple the Vacation Watch form which is available two ways:

1. On the TPOA website <http://www.tpoa.net/VacationWatchForm.pdf>
2. On line on the City website http://www.tampagov.net/dept_Police/Files/Documents/Vacation_Watch_Form_Prefill.pdf

For more information contact Lisa Timmer, telephone 931-6541, Email Lisa.Timmer@Tampagov.net .

4. The lights are on but no one's home

Consider purchasing a light switch timer that can turn your lights on and off automatically according to a programmed schedule.



5. Stop your mail

Either place a “stop” order on mail and or arrange to have a friend or neighbor pick up your mail while you're away. To put your mail on hold, just go to the Postal Service web site and fill in the form.

<https://holdmail.usps.com/holdmail/landingView.do>



“Florida Friendly” Does Not Mean Barren



It is almost inescapable - from HGTV to the regulatory agencies like SWFWMD or the City of Tampa to the market pressure of what home buyers say they want - Florida Friendly landscape is here to stay.

The yards with nothing but lush green (and water hogging) grass outlined with prim little shrub beds along the house are to landscape what avocado-colored appliances are to kitchens or big-hair styles are to class pictures... neat, iconic and so not today.

But what does “Florida Friendly Landscape” (FFL) really mean? At a recent TPOA meeting one concerned resident worried that the pressure was on to rip out all lush landscape and replace it with desert-like stones, rocks and mulch. Not true.

FFL is a set of landscaping principle that focus on

- Conserving water resources
- Minimizing landscape maintenance
- Optimizing use of pesticides and fertilizers

Those principles were detailed in previous newsletters and are outlined in the information from the Tampa Palms landscape seminars which can be found online at <http://www.tpoa.net/FFYWorkshop1.pdf>

There are many expressions of FFL; many incorporate strategically placed turf, many are exceptionally lush - some far more so than a grass-only yards.

Modern Transitional - Large curving beds around trees, breaking up and reducing turf areas.

Contemporary Urban Chic - Flowering plants interspersed with green shrubs and stone paths or other concept-based elements.

English Garden Formal - Formal, multi-layer greenery laid out in a symmetrical manner .

Butterfly Friendly - Flowering native shrubs, a master gardener’s retreat.

FFL does not mean the practice of removing failing turf and placing it with just a few plants irregularly spaced. Plants must be of a specified size and planted at specific distances. When planning to modernize your landscape, draw a plan and submit to RMC– as required. The TPOA will be glad to make suggestions to help you with compliance.

Tampa Palms Landscape Principles

Attractive & Well Groomed

Weed-Free Beds

Drives and Beds Properly Edged

Foundation Plants Around Home

Trees & Shrubs Cover A Minimum 25% of Front of Home - No Maximum

All Upright Shrubs Minimum 3 Gal At Planting

Hedge Shrubs Minimum 3 Ft At Planting

Hedge Shrubs Planted Minimum 3 Ft On Center

Spreading Shrubs 1 Gal Minimum At Planting

Ground Covers Minimum 4 In Pots 6 In On Center

Areas Not Landscaped With Plants Must Be

Planted With Turf Or Ground Covers or

Feature Attractive Design Elements



Tampa Palms Garbage &

As previously reported, the garbage and recycle collection services provided by Hillsborough County will change this year– new services in place by October 1.

What stays the same

- Garbage will be picked up twice a week
- Recycling will be collected once a week
- Yard waste will be collected once a week

What is changing

- The company providing collections (Waste Services for Tampa Palms instead of Waste Management)
- The days for pick-up may change
- The type of collection trucks will change
- The size, type of garbage and recycle containers.
- The materials that can be recycled.

What is the schedule?

Hillsborough County Commissioners have awarded new contracts for the collection of garbage and recyclables in the County’s service area.

Under the new agreements, the County will provide each home with a new garbage container and a new recycle container prior to the new service going into effect.

Deliveries of the new containers will be made beginning in August. The date for the Tampa Palms deliveries has not yet been established, it may be later– close to the time of the new service.



On October 1, 2013 the new automated garbage and recycle collection will go into effect. The exact days of the week for Tampa Palms collections have not yet been established but the citizens and the TPOA will be notified in advance of the start date.

What type of containers will be used?

The new services will be automated so the containers will be roll off-style, capable of being lifted by the truck.

The garbage containers - picked up twice per week- will be 95 gallon and gray in color. The recycle container, which is slightly smaller, will be 65 gallon and blue.

The dimensions of each type of containers, as provided by the County on their website, are shown below.



The containers are designed to be rolled from the garage to the street on the day of collection just as is done today. The new bins are heavy-duty so they are substantially more critter-resistant than the standard residential bins in common use today. (It is never a good idea to underestimate the perseverance of a Tampa Palms bob cat or even a raccoon so putting them out on day of service is still a good idea.)

The bins are larger and one reason for the size enhancement is this - no additional garbage bags placed beside the bins will be picked up– only the bins will be emptied.

Residents’ old containers will be picked up after the new service is started– if residents want to dispose of them.



Trash Collection Changing....

New collection trucks take over.

The new collection trucks have three parts:

- The main storage compartment, at the rear
- The driver's compartment
- A Curotto-Can in front of the driver which initially receives the garbage

The collection trucks have a slimmer silhouette and will run on condensed natural gas (CNG) so they are quieter and have fewer emissions than diesel trucks.

A lift-arm on the truck picks up recycling or trash containers and empties them into the Curotto-Can. When the



Curotto-Can is filled after 10-15 pick-ups; it is lifted over the cab and emptied into the main compartment. The operator can select the location for emptying it, making certain that Tampa Palms trees are protected.

With the container emptying occurring in front of the driver, he can observe the effectiveness of the process, correct for any problems and reduce spillage on the streets.

The driver does not normally leave the vehicle. In part this is the reason that only the proper containers can be used and no garbage bags placed beside the containers will be collected.



Recycling is easier and better.

Each home will receive a blue 65 gallon recycling bin. Like the garbage bins, the new recycle containers are heavy duty, equipped with a tight seal lid and may easily be rolled to the curbside for collection.

With the automated services and the new recycling bins household recycling has been made much easier:

- Recycling is single stream, nothing needs to be separated by the homeowner.
- More products are accepted for recycling (all plastics 1-7), glass, paper, metal containers, aseptic containers (juice boxes) and plastic film when placed in a single plastic bag.



Special services made available

Seniors who qualify for the Senior Discount, or those with physician - certified medical needs may elect different collection containers with *Senior Choice*:

- Choice 1: a 65-gallon cart for garbage, and a 65-gallon cart for recyclables
- Choice 2: a 35-gallon cart for garbage, and a 35-gallon cart for recyclables

While it is too late to register for the first time for Senior Discount this year, the program remains open and those who qualify can receive a discount on the garbage disposal costs on their future tax bills. There will be more information on this program in a future newsletter or you can go on-line to <http://www.hillsboroughcounty.org/index.aspx?NID=2945>.

For those who are part-time residents or have very small garbage collection needs, 65 gallon containers will be made available in mid January. Details on how to "trade in" the large bins will be announced later.

Questions About A “For Sale” Sign On Conservation Land

Many Tampa Palms residents have contacted the CDD or the TPOA to inquire about a “for sale” sign that appeared on the north side of Tampa Palms Blvd - between the TP village of Wyndham and the TPOST village of Tuscany.

The land that is being offered for sale is a lowlands tract that stretches from the power line easement across from Compton Park, wraps around Wyndham and then continues behind the homes along Yardley Way in the Enclave, and ends at I-75.

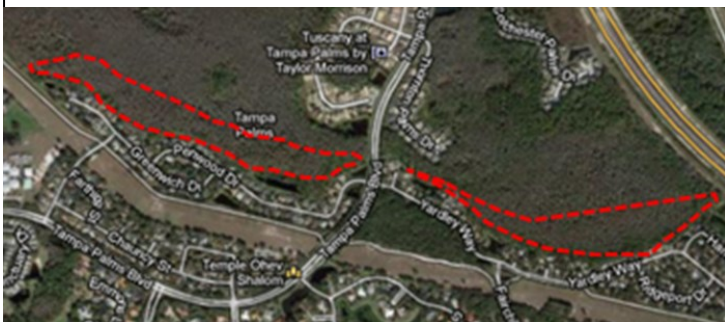

These tracts do not cross Tampa Palms Blvd: there is a strip of land along the boulevard owned by developer of TPOST.

The land that is for sale is not owned by or even under the jurisdiction of either the CDD or the TPOA. (It is also not located in Tampa Palms, it is in the TPOST CDD.)

This parcel is a portion of land retained by the original developers of the area and later sold for the taxes.

The current land-use designation for the property is “lowlands” and presumably this land cannot be cleared for development. Inquiry has been made of the City to clarify what activity can take place on it.

Anyone desiring information about the City’s response before the next newsletter may call the CDD at 977-3933.



Hurricane Season Are You Prepared?



While it is true that Tampa Palms does not share the extreme exposure to hurricane dangers of the more costal areas, hurricanes are powerful storms and this area is by no means immune to their effects.

High winds and pounding rains can cause tree damage, structure damage and road flooding, as seen at the bottom of the page at the entrance to Stonington. Hurricanes also spawn tornados which can cause devastating damage.



CoreLogic in its 2013 Storm Surge Evaluation Report lists Tampa as number 4 in the top ten metropolitan areas that are at risk for storm surge damage. While Tampa Palms seems safe from storm surge, it is not safe from its effects:

- The power for Tampa Palms is generated in facilities which might be shut down in the event of a hurricane event- particularly one with storm surge.
- The sewage treatment facilities are located along the bay and might not be operating in a surge/no power situation.
- The pumping stations that take the sewage out of Tampa Palms might not be operating if power is lost.

The key is to prepare in advance and have a plan that includes at a minimum:

- ✓ Water & non perishable food for at least 3 days
- ✓ Flashlights, batteries and portable radios
- ✓ Medical supplies, prescriptions and routine medicines

Hillsborough County has created a comprehensive Hurricane Guide which is available on line to help you plan for your family and pets. You can go online to:

<http://www.tbrpc.org/tampabaydisaster/>



City, TPOA and CDD Gather At May CDD Meeting

City Councilwoman Montelione & TPOA President Bill Edwards joined May CDD Meeting. One of the major topics of discussion was the plan in progress to retain the community quality of Tampa Palms, even as Bruce B Downs is widened to 8 lanes.

It was mentioned in the meeting that Tampa Palms is unique in this experience because no other community along the BB Downs corridor (or in the county for that matter) is split in half by a roadway that is wider than most interstate highways.

The community planning team of Hardeman Kempton is addressing this situation with creative plans that will

- Retain the community atmosphere within Tampa Palms along BB Downs
- Serve as a bridge linking the two halves of Tampa Palms into a continuous whole.

The first order of business is the main entry - east side. There the need to create additional turn lanes will result in the loss of the brick walls, as well as, major oak trees and a significant portion of the irrigation system that runs the entire entry.

Preliminary restoration plans were presented and will be discussed in more detail at the June CDD meeting.

A community report detailing the challenges and plans to maintain Tampa Palm signature look is available on the TPOA web site line at <http://www.tpoa.net/CommunityReportTPSignature2017.pdf>



CDD Publishes 2013-14 Budget

The proposed budget for FY 2013-2014 was presented this month for preliminary approval. This approval is necessary to send notice to the owners of the upcoming Budget Hearing which will be held in July.

**Budget Hearing
Wednesday July 10th
6 PM, Compton Park**



This budget is based on the Board's multi-year financial model (*Five Year Model FY 2012-13 – 2016-17*). Consistent with that model, assessments will continue at the reduced rate, which was previously adopted for the FY 2012-13 budget.

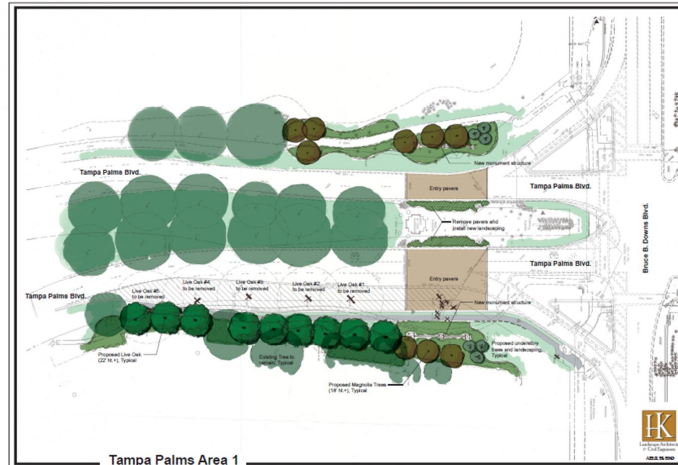

This budget maybe modified by the Board between now and the Budget Hearing date though the assessments may not be increased once the public notice is made.

Revenues

As planned, the assessments will continue at the same levels assessed in FY 2012-13. for the five fiscal years through FY 2016-17.

Expenditures

Normal operations increased by \$ 66 K over FY 2012-13. Project driven expenses decreased \$66 K.

The Proposed Budget is available online at <http://www.tpoa.net/ProposedFY2013-14Budget.pdf>

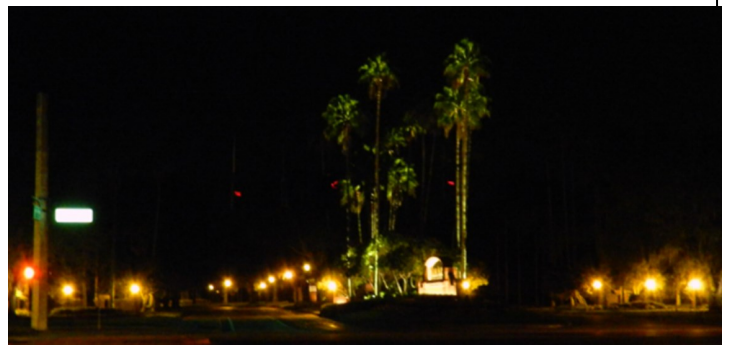



New Tampa AM Rotary Club

The weekly club breakfast meeting of the **New Tampa AM Rotary** are held on Friday mornings at 7:00 AM at the Tampa Palms Golf and Country Club, 5811 Tampa Palms Blvd.

Upcoming speakers include:

May 31 Sr. Babtunde, Principal “St. Peter Claver Catholic School”
Speaking of St Peter Claver, Sister Babtunde says, "Children are the same all over the world. They respond to love, consistency, compassion and respect for their unique gifts and talents. There is an abundance of these virtues at St. Peter Claver."



June 6th Vicki Sokolik “Starting Right, Now-a Snapshot” Vicki Sokolik , founder “Starting Right, Now “ will discuss this program aimed at meeting the needs of the growing population of homeless families and children in Hillsborough County



June 13 Megan Corry “Rotaract Spotlight on the Year.” Megan Corry is President of the USF Rotaract, an affiliate of Rotary International which acts to bring opportunities to express service above self to college campuses.



June 21 Tom Novak, Mader Law Group - “BP Oil Spill and Economic Recovery”

Community Director: Jo Ann Conrad
Property Manager: Bonnie French

16101 Compton Drive M-F 9 AM - 5 PM
Phone: 977-3337
Fax: 978-8067
E-Mail: tpoamail@aol.com
Web Site: www.tpoa.net

Board of Directors

Bill Edwards, President 972-4238
Barbara Shimer, Secretary 971-8063
Jake Schoolfield, Treasurer 998-2620
Marianne Trubelhorn , Director 977-3337

CDD

16311 TP Blvd. West
Maggie Wilson, Consultant
Phone: 977-3933
Fax: 977-6571
E-Mail: cdd.tampa@verizon.net

CDD Board of Supervisors

Gene Field 977-1162
Patty Maney 977-7129
Andy Miller 979-0225
Randy Marlowe 866-1091
Bill Shimer 971-8063

One Source (Landscaping)

Joe Laird, Area Manager 267-1756

Tampa Palms Parks

Compton Park 972-0897
Hampton Park 972-5699
River Park 971-6241

Police & Fire

911

Non-Emergency Police 231-6130
Non-Emergency Fire 223-4211

Local Schools

Tampa Palms Elementary 975-7390
Lawton Chiles Elementary 558-5422
Liberty Middle School 558-1180
Freedom High School 558-1185

Miscellaneous

Street Repairs 622-1940
TECO 223-0800
Waste Management 621-3053
Water Department 274-8121
New Tampa Rec. 975-2794
Stormwater (Floods or Dumping) 622-1901



June-July 2013 Calendar



June 2013



Drive with care, the last day of school is June 7th





1
5-10 Private

2 9-12 Private Event 1-7 Private Event	3 9-11 Private Event 6-7 Private Event	4 1-4 Private Event 6-7 Private Event	5 10-12 Private Event 12:30-1:30 Private Event 3-5 Private Event	6 10-2 Women's Club 7-9 Private Event	7 9-12 Children Music 12:30-1:30 Private 5-10 Private Event	8 11-4 Private Event 5-10 Private Event
9 9-12 Private Event 3-8 Private Event	10 9-11 Private Event 6-7 Private Event	11 12-4 Les Girls Art 6-7 Private Event	12 10-12 Private Event 12:30-1:30 Private Event 3-5 Private Event	13 10-2 Women's Club Bridge  7-9 Private Event	14  9-12 Children Music 5-10 Private Event	15 11-4 Private Event 5-10 Private Event
16  9-12 Private Event 1-5 Private Event	17 9-11 Private Event 6-7 Private Event	18 6 PM TPOA Board	19 10-12 Private Event 12:30-1:30 Private 3-5 Private Event 6-9 Nottingham HOA	20 7-9 Private Event	21 9-4 Private Event 5-10 Private Event	22 10-3 Private Event 5-10 Private Event
23 9-12 Private <u>3-8 Private Event</u>	24 9-11 Private Event 7-9 Faircrest HOA	25 12-4 Les Girls Art 6-7 Private Event	26 10-12 Private Event 12:30-1:30 Private 3-5 Private Event 6-9 North Tampa Arts	27 10-2 TPWC Bridge 	28 12:30-1:30 Private 5-10 Private Event	29 11-4 Private 5-10 Private
30 9-12 Private Event 2-7 Private Event						



July 2013



30 9-12 Private Event 2-7 Private Event	1 9-11 Private Event 6-7 Private Event	2 1-4 TPWC 6-7 Private Event	3 10-12 Private Event 3-5 Private Event 6-9 Fly Fishing	4  5-10 Private event	5	6 11-4 Private Event
7 9-12 Private Event	8 9-11 Private Event 6-7 Private Event	9 12-4 Les Girls Art 6-7 Private Event	10 10-12 Private Event 12:30-1:30 Private 3-5 Private Event 6 PM CDD Meeting	11 10-2 Women's Club Bridge  7-9 Private Event	12 10-11 Private Event 5-10 Private Event	13 11-4 Private Event
14 9-12 Private Event 1-6 Private Event	15 9-11 Private Event 6-7 Private Event	16 1-3 TPWC Board 6-7 Private Event 6 PM TPOA Board	17 10-12 Private Event 12:30-1:30 Private 3-5 Private Event	18 7-9 Private Event	19 10-11 Private Event	20 10-4 Private Event 5-10 Private Event
21 9-12 Private Event 3-8 Private Event	22 9-11 Private Event 7-9 Faircrest HOA	23 12-4 Les Girls Art 6-7 Private Event	24 10-12 Private Event 12:30-1:30 Private 3-5 Private Event 6-9 North Tampa Arts	25 10-2 TPWC Bridge  3:30-8 Private Event	26 10-11 Private Event	27 11-4 Private 5-10 Private
28 9-12 Private Event 1-6 Private Event	29 9-11 Private Event 12-2 Private Event 6-7 Private Event	30 9-2 Private Event 6-7 Private Event	31 10-12 Private Event 12-2 Private Event 3-5 Private Event			

Tampa Palms CDD Meeting Agenda

**June 12th at 6:00 p.m.
Compton Park Recreation Building
16101 Compton Drive, Tampa, FL 33647**

1. Roll Call
2. Pledge of Allegiance
3. Strategic Planning
4. Public Comments
5. Board Member Discussions
6. Project Updates
 - BB Downs Update
 - Park Reviews
 - LED Lighting
7. Misc. Board Business
8. Public Comments
9. Board Member Discussions
10. Adjourn

Liberty Middle School “Spring Finale” Concert Was a Charmer

Liberty Middle School’s Choral Department presented a “Spring Finale” on May 28, 2013. Students wore summer-themed outfits and performed songs with positive messages including “Don’t Stop Believin’,” “True Colors,” “My Heart Will Go On,” and “Walking on Sunshine.”

Mr. Joseph Canessa, Choral Director, also took the opportunity to present awards to the “MVP”s from each period as well as to recognize the special achievements of students who were selected for the All-County and All-State Choruses. At the end of the show, Mr. Canessa said, “This has been a fantastic year, We are all excited for next year.”

