



# Tampa Palms CDD January, 2018

# Agenda

- Roll Call / Pledge of Allegiance
- Jason Rinard / Hardeman Kempton
- Strategic Planning
- Board Member Discussion Items
- Public Comments
- Consultant Reports
- Other Business
- Public Comments
- Board Member comments
- Adjourn

# Jason Rinard

## *Making The Pond An Amenity*



Planting Options  
Adjacent Landscape  
Board Feedback

# Strategic Planning

	<u>Next Step</u>	<u>Date</u>	<u>Responsible</u>
<b>BB Downs Restoration</b>			
General Progress/ Turnover	Update	Jan	Staff
Entry Upgrades	Update	Jan	Staff
Pond / Littoral Plantings	Report	Jan	J Rinard
Landscape/ Amberly	Report	Jan	Staff/Maney
<b>Community Appearance</b>			
General Landscape	Report	Jan	Staff/Maney
Frost Damage	Report	Jan	Staff
Irma/Tree Report	Report	Jan	Staff

# Strategic Planning

	<u>Next Step</u>	<u>Date</u>	<u>Responsible</u>
<b>Parks</b>			
Cleaning/ Repairs	Update	Jan	Staff
Signs	Report	Jan	Staff
<b>Storm Water Pond Management (NPDES)</b>			
Sidewalk Drainage	Review	Jan	Staff



# Board Member Discussion

The CDD Public meetings are the only opportunity that Board members have to discuss community issues between themselves. This time is set aside for Board Member discussions.



# Public Comments

The Public is encouraged to speak on any matter, on or off the agenda.

# Approval of Minutes

The Board will review and approve the November, 2017 meeting minutes



# Approval of Disbursements

Each month as part of the Board oversight responsibilities, the Board approves the CDD disbursements.

Disbursements for the months ending:

October 31, 2017 were \$269,141.28

November 30, 2017 were \$147,903.89

# Consultant Reports

New District Manager

Bruce B Downs Restoration

2018 Forward- Annual Review

Community Appearance

Park Updates

# Bruce B Downs Restoration

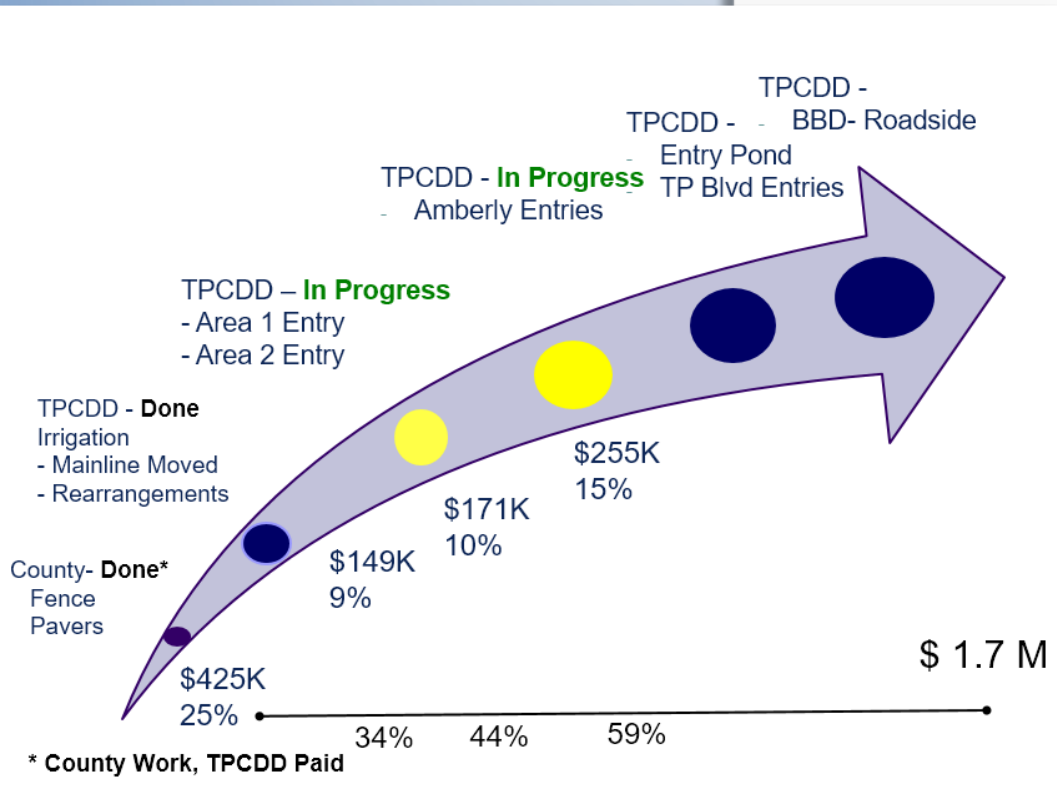

## Known

- Paving Complete
- Fencing Complete
- Scope of Work

## Not Known

- Pond Access
- *Normal* Pond Level

# ***Bruce B Downs***

## ***Restoration***



### **Commencing**

#### **Amberly Quadrant**

### **In Process**

- Restore Irrigation
- Spray Out Weeds
- Remove Dead Shrubs
- ? Remove Sidewalk

### **Next Steps**

- Re-sod
- Renew Plantings

# Bruce B Downs

## *Main Entries*



### Medians

- Palms & Ligustrum Done
- Annuals Planted
- New Shrubs - Front Area
- Tree Rings Removed - 3 Wks
- Stakes Removed - 3 Months
- Understory Plants Follow

# Bruce B Downs

## *Emergency Repairs*



### **Median Planters Not Secure**

- Block W/ No Rebar
- Block Cells Unfilled
- Bricks On Top Of Block

### **Fully Repaired**

- Required Power Re-Wire
- Irrigation Reinstallation





# ***Tampa Palms Welcomes New District Manager***

## **Bruce St Denis**

- Accepted City Manager Position
- Resort City in Oregon

## **Welcome Paul Cusmano /DPFG**

- 20 Years Experience Community Creation & Construction
- Oversees Other Local CDDs

## **Requires Formal Appointment**

- Resolution 2018-1

# 2018 Forward- Annual Review

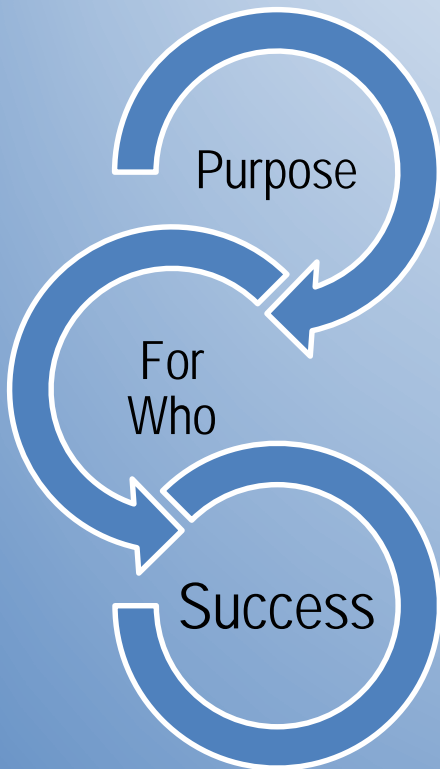

## **Governing Documents**

Examine For Clarity

Adjust If Indicated

- Mission
- Direction
- Values
- Roles



# 2018 Forward- Annual Review

## Leadership

Financial & Resource Management	Field
Government Liaison	Vaughn
Landscaping and Community Appearance	Maney
Irrigation System & NPDES	Gibson
Infrastructure and Facility Oversight	<u>Soley</u>

# Park Updates

## Hampton & Amberly Cleaned

- Tables/Benches/Sidewalks
- Play Equipment/Umbrellas
- Roofs

## Rotting Wood Small Pavilion

- Replaced & Repainted
- ## New Signs In Place



# Community Appearance



## **First Frost in 4 Years**

- More Cold Predicted

## **Two Edged Sword**

- Damages Annuals/Plants/Turf
- Manages Fugus & Vines

## **Not Overall Exposure**

- Some Areas Hit/ Some Not
- Unsure Turf Impact
- Powerline Areas Hit

# Community Appearance



## Irma Clean-Up Complete

- CDD-Owned Areas
- 61 Downed Trees
- Substantial Damage Oak Park
  - Cleaned In Oct
  - More Dead This Week

# Community Appearance



## Drainage Issues

- Flooded Sidewalk (City)
- 20 Years
- Gas Line In Area

## Bio-Swale (NPDES Project)

- Fixed Flooding At Compton
- Working With City
  - No Drains Available
  - Checking For Solution



# Public Comments

The Public is encouraged to speak on any matter, on or off the agenda.

# Board Member Discussion

This final time is set aside for  
Board Member discussions.

# Adjourn







## SPECIFIC ANALYSIS AND SCHEMATIC DESIGN APPROACH:

1. Provide an overall graphic, digital model of the proposed corridor widening overlaid onto an existing aerial. The objective is to help convey the impacts of the widening that aren't always understood in construction plan (2D view) documents. This model will address all the sections of interest including the Pond 300 project which has already been presented to the CDD. ✓
2. Identify opportunities/ constraints of the proposed widening in each of these areas. ✓
3. Identify design components that will help carry the Tampa Palms brand along the B.B. Downs corridor. ✓
4. Prepare and present design solutions for review/ consideration by the CDD Board. Refine as needed.
5. Prepare final recommendations and allocated budgeting for approval by the CDD Board. At this stage we will have a defined solution for these areas with CDD participation and as part of the budgeting we will include our design fees to prepare construction documents and assist with permitting.



- Pond 300 Summary
- ❑ Fill and planting of corner wetland
  - ❑ Beneficial planting – littoral shelf
  - ❑ Landscape along Bruce B. Downs Blvd
  - ❑ Landscape improvements to Tampa Palms Blvd
  - ❑ Landscape Amberly Dr

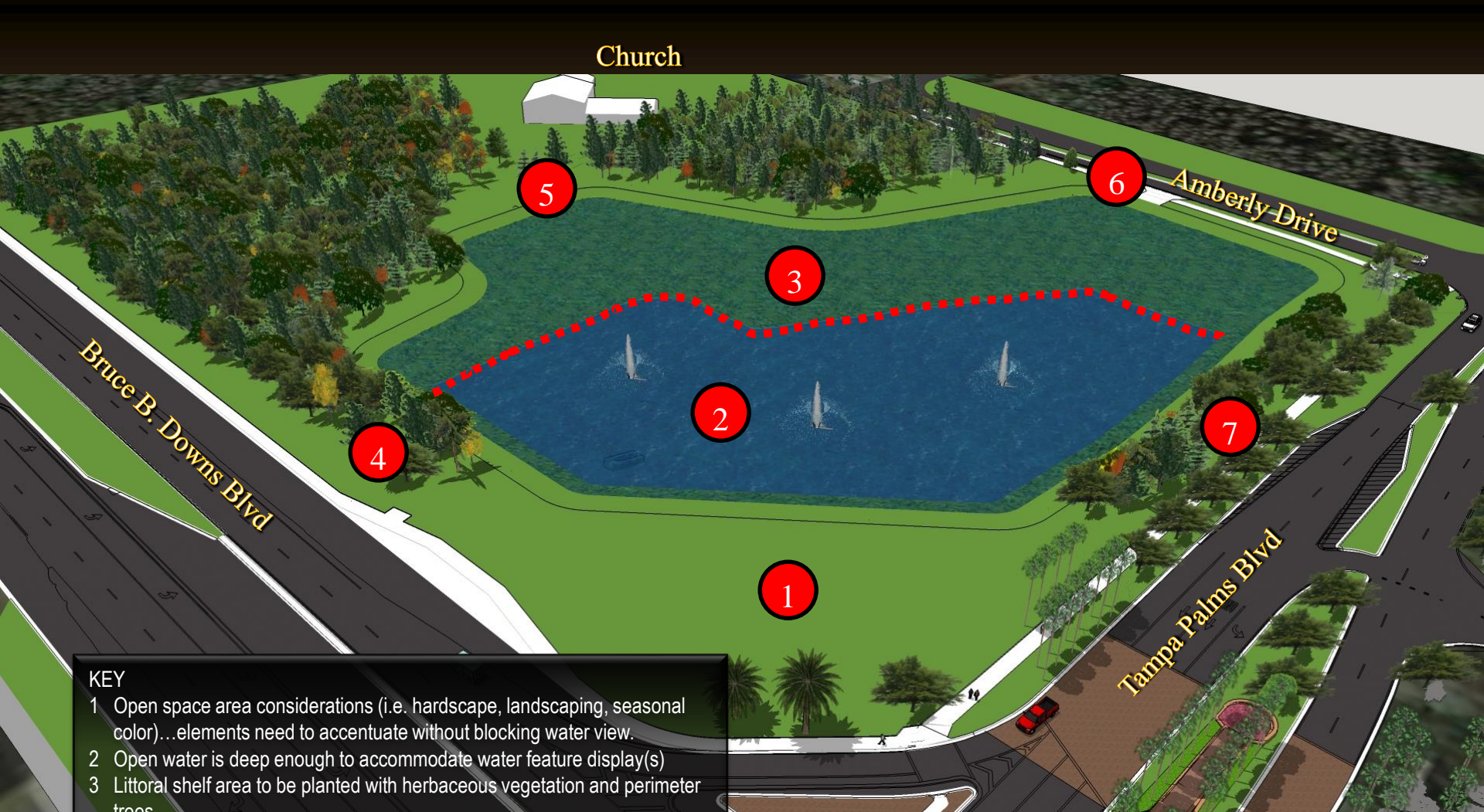

**KEY**

- 1 Open space area considerations (i.e. hardscape, landscaping, seasonal color)...elements need to accentuate without blocking water view.
- 2 Open water is deep enough to accommodate water feature display(s)
- 3 Littoral shelf area to be planted with herbaceous vegetation and perimeter trees.
- 4 Existing tree canopy to be cleaned up from underneath to promote views
- 5 Landscape screening considerations to block view of adjacent buildings
- 6 Amberly Drive view has a passive park like experience.
- 7 Tampa Palms Boulevard view can be enhanced.

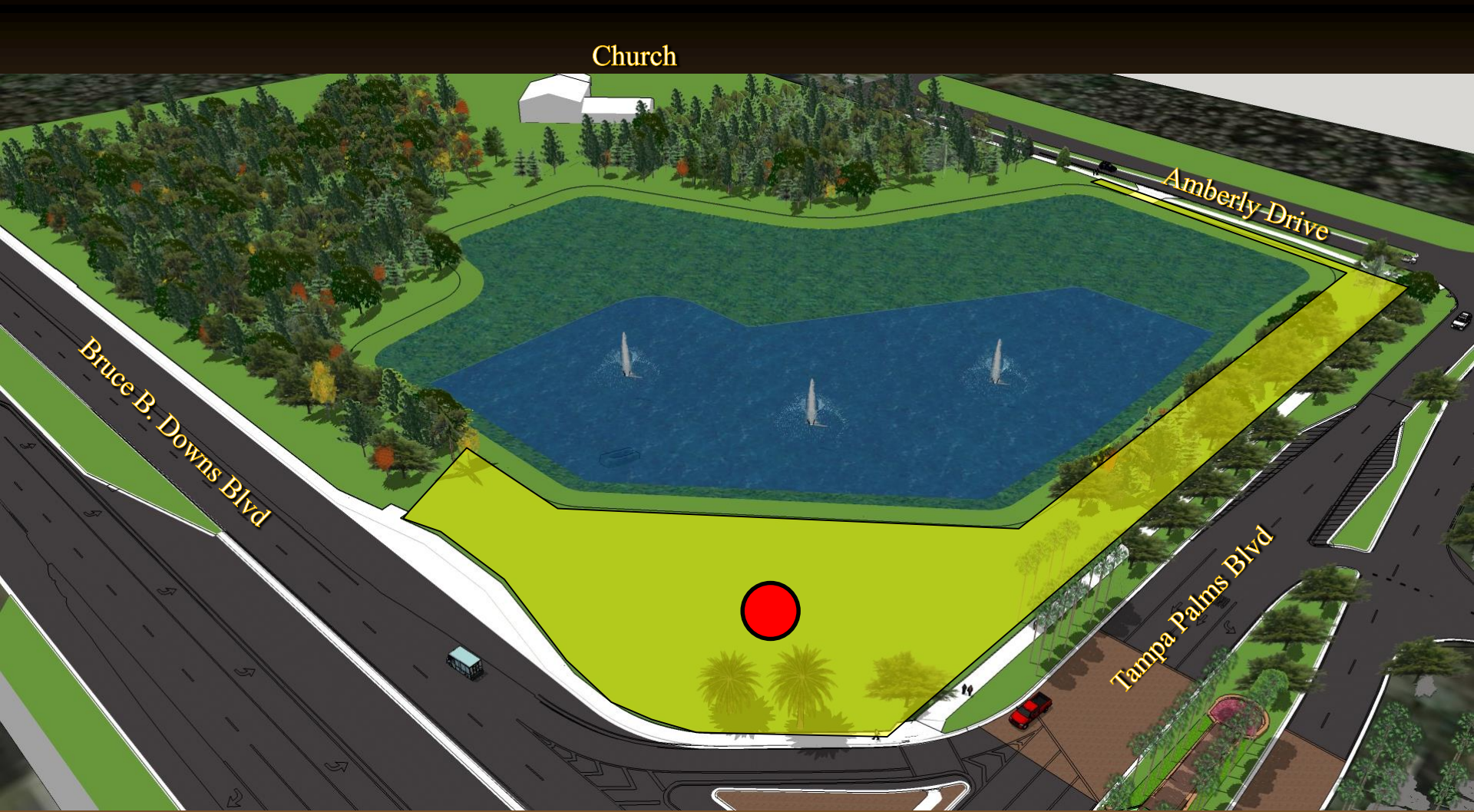



KEY

- 1 Maintenance Berm (36" to 48" ht.) runs along pond perimeter
- 2 Open water is deep enough to accommodate water feature display(s)
- 3 Littoral shelf area to be planted with herbaceous vegetation and perimeter trees.

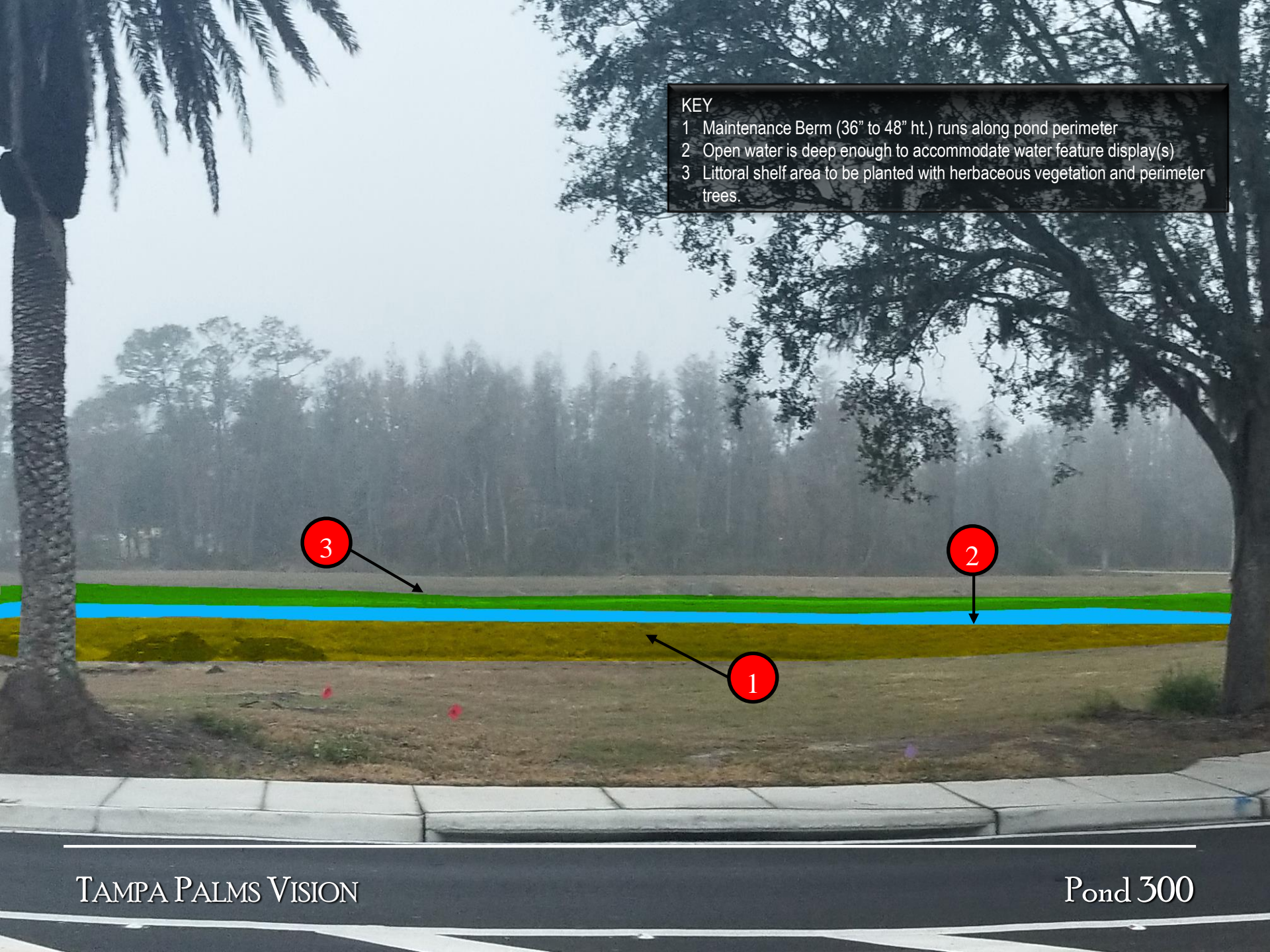

KEY

- 1 Maintenance berm (36" to 48" height) – top of bank
- 2 Expand berm on CDD parcel. Undulate and integrate plantings for visual appeal.
- 3 Expand existing grade and provide accent plantings along edge.
- 4 Expand and transition grade. Integrate tiered plantings and potential hardscape feature

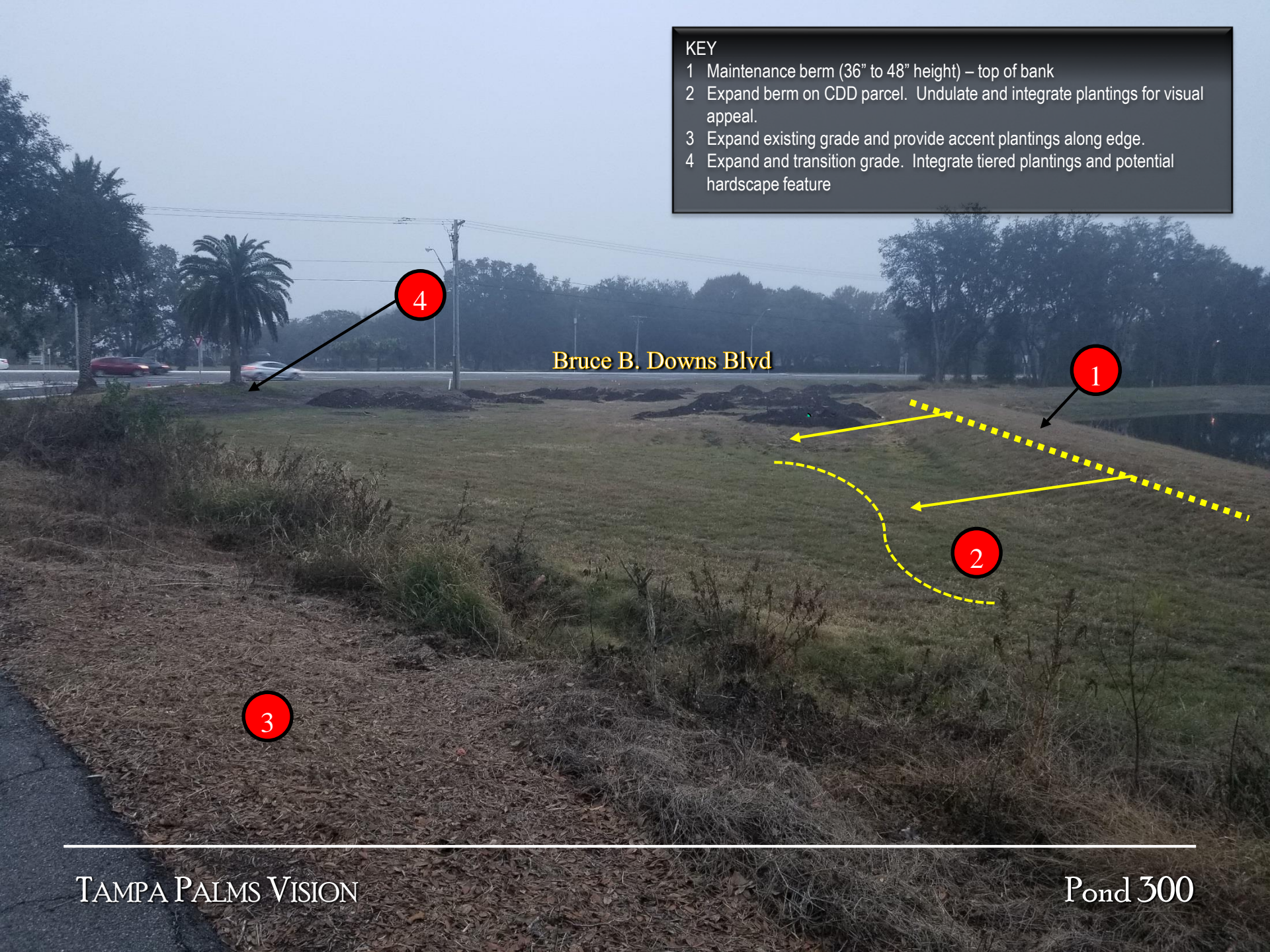

Bruce B. Downs Blvd





KEY

- 1 Open water
- 2 Littoral shelf unplanted with some natural vegetation recruiting
- 3 Provide accent plantings along perimeter and possible trees on upland side along Amberly Drive.

Bruce B. Downs Blvd



Tampa Palms Blvd perimeter

Amberly Drive perimeter

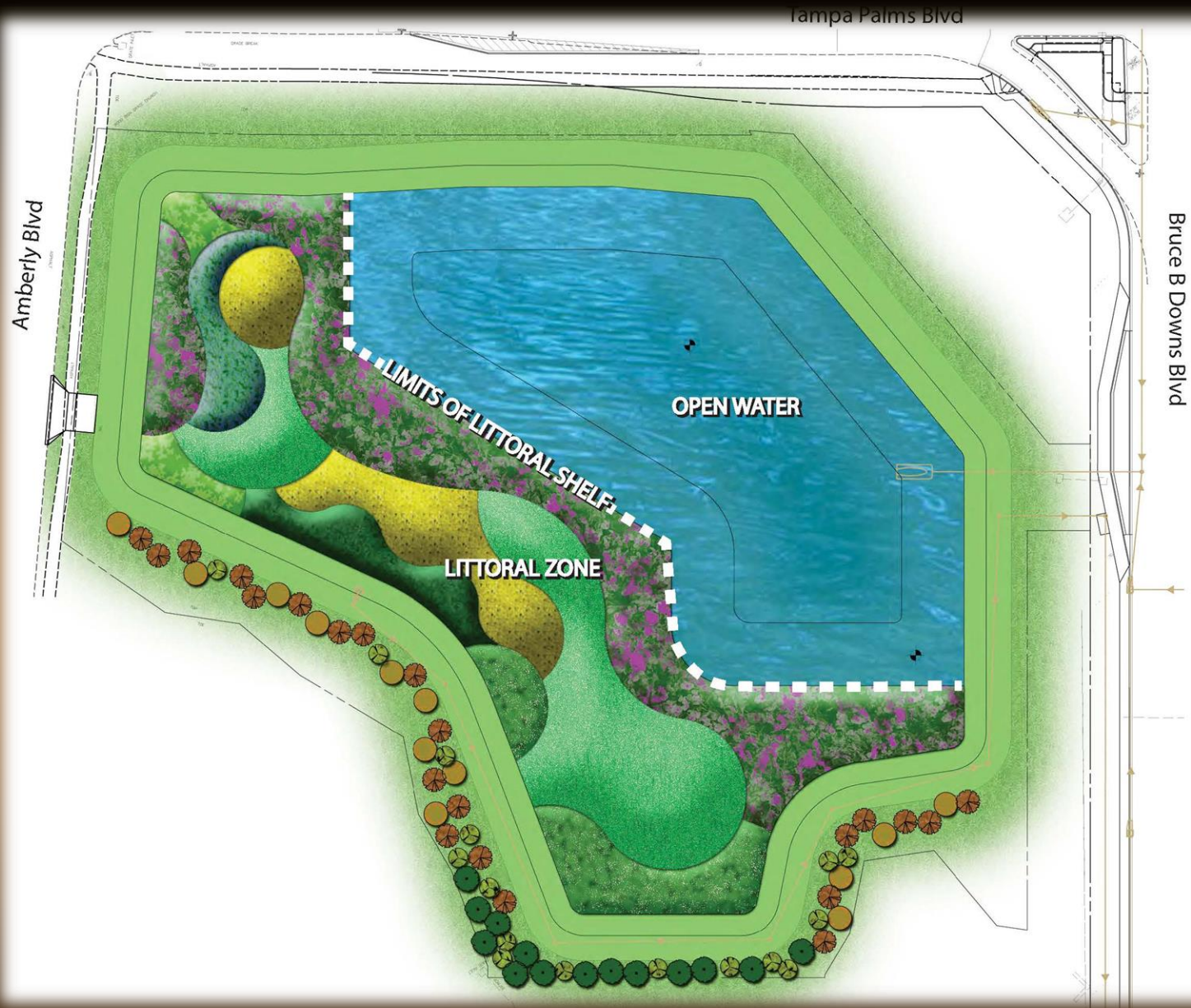



Muhlenbergia capillaris - Muhly Grass



